

# Mesh Face Shield

## SWS-FP1902



### + Features

Reference certificate	GuardRite/M-5004A
Material	HDPE
Suspension system	2 attachment points with ratchet adjustment
Sweatband	Soft sponge
Face protection	Perforated metal
Colors	 Yellow   Black
Certifying organisation	Alienor Certification (Notified Body: 2754)
Certifications	CE EN 1731:2007
Sizes	Unique



### + Description

The SWS-FP1902 perforated metal protective visor is designed to protect the wearer's face. Ideal for continuous use. Its excellent construction offers high comfort, and thanks to its adjustment ratchet it adapts perfectly to the wearer's head. Its sweatband and superior ventilation system help to eliminate heat for prolonged use.

### + Activity Sectors



### + Maintenance

Clean after each use to extend its lifespan. Sanitize the visor and its components using running water or neutral cleaning liquids. Dry cleaning is not recommended. Do not use paints, solvents, chemicals, adhesives, fuels or similar substances. Impact resistance and other protective properties may be compromised by these substances. The loss of these protective properties may not be apparent or readily detectable by the user.

# Mesh Face Shield

# SWS-FP1902



## + Pictogram Explanation

	Protective mesh visor		Adjustable visor angle
	Roller for a perfect fit on the head		Open back for greater ventilation
	Soft band for sweat absorption		

## + References

Reference	Color	EU Size	Bar Code unit	Bar Code Box of 8 un	G.W. box of 8	N.W. box of 8	Box size (CxLxH)	Shipping box quantity	G.W.	N.W.	Shipping box size (CxLxH)	Bar Code shipping box
<b>SWS-FP1902</b>	Yellow   Black	Unique	5600992409482	5600992410013	2,25 kg	1,96 kg	67x24x30 cm	4 boxes (32 uns)	10,00 kg	7,84 kg	70x50x63 cm	5600992410044

## + Mounting and Adjusting the Visor

Assemble the Protection Visor according to the instructions below

### VISOR ANGLE ADJUSTMENT

There are 4 available angle positions (Img. 1) to adjust the distance between the eyes and the visor.

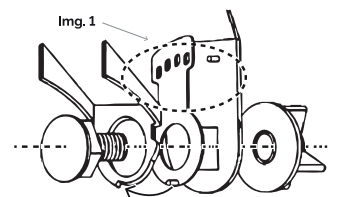

### PLACEMENT OF VISOR

1. Insert the central hole in the visor (Img. 2)
2. align it with the hole in the support (Img. 3)
3. Then insert the holes in the visor into the rotating "posts" of the support (Img. 4)
4. When they are all inserted, turn the "posts" to fix the visor (Img. 5)

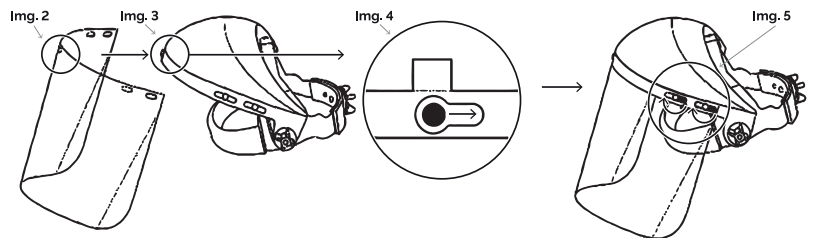

### FITTING THE HARNESS TO THE HEAD

1. Push the adjustment roller (Img. 6) inwards
2. Without letting go of pushing, turn the roller to expand or contract the strap until the headgear adjusts to the head correctly (Img. 7)

